



# Jeanneau Merry Fisher 605 - Series 2

£58,995 • Brightlingsea United Kingdom (UK) • New • 2025

## Presented by

Peter Marchant  
Phone: 44(0)1206302003

**Morgan Marine**  
The Boatyard, Shipyard  
Estate  
CO7 0AR Colchester  
United Kingdom (UK)



## Details

Make:	Jeanneau
Model:	Merry Fisher 605 - Series 2
Year:	2025
Condition:	New
Engine:	, 250 hp
Engine type:	
Fuel type:	Gasoline
Length:	6.65 m (21.82 ft)
Beam:	2.44 m (8.01 ft)
Cabins:	0
Berths:	0



Morgan Marine



7zea.com

# Description

EN

2025 Jeanneau Merry Fisher 605 with Honda BF100 outboard and a saving of almost £6,500 from the RRP. Over £15,000 extras including Trim Level Premiere, upgraded electronics, U-shape cockpit saloon, GRP bathing platform + more! A very popular wheelhouse fisher / cruiser - great for day trips with friends and family. Suitable for a trailer on UK roads and easy to launch and retrieve. Delivered to Morgan Marine with full PDI / commissioning / installation, 3 piece name set and hand over package. CE category C for 6. This 2025 model year Jeanneau Merry Fisher 605 is in stock at Morgan Marine and available for viewing 7 days a week. NB - library photos may not reflect specification of boat.

Deck: Self draining anchor locker + bow roller. 2x forward chocks, 2x forward cleats and 2x aft cleats. Open front pulpits. Cockpit handrails. Aft cockpit sliding bench with cushions and removeable corner seats. Deck locker. Swim ladder and cockpit barrier. Self draining cockpit. Hull rubrail. Ring for trailer. Mooring kit - fenders and ropes. Anchoring kit - anchor + chain. U-shape cockpit saloon & sundeck complement (seats + table + sundeck cushions). GRP bathing platform.

Cabin: Double berth. Space for chemical toilet. Saloon convertible into berth. Opening roof hatch.

Cockpit: Wheelhouse with aft transparent sliding door, port + starboard sliding windows + roof hatch and front windscreen with port + starboard electric windscreen wipers + screen wash. Starboard side helm position with pilot bolster seat, dashboard with engine controls and electronics. Port side saloon table with lockers under seats + overhead lighting. Forward facing co-pilot bench seat - converts to seating at table. Starboard side galley behind the pilot seat with sink, manual pressurised water, 42L 12v fridge, space for removable gas stove.

Electronics: Upgraded Garmin Electronic Pack: Garmin echoMAP UHD2 92sv touchscreen, GT23M-TM transducer. Navigation lights.

Machinery: Honda BF100 LRTU. Mechanical steering. Manual and electric bilge pump. Fuel capacity: 100L - with outside fill. Water capacity: 50L.

## General information

Make:	Jeanneau
Model:	Merry Fisher 605 - Series 2
Year:	2025
Condition:	New

## Engine

Engine:	, 250 hp
Engine type:	
Fuel type:	Gasoline

## Measurements

Length:	6.65 m (21.82 ft)
Beam:	2.44 m (8.01 ft)
Deep:	0.45 m (1.48 ft)
Weight:	0 ( )

## Accommodation

Cabins:	0
Berths:	0

# Images



Jeanneau Merry Fisher 605



Jeanneau Merry Fisher 605 - aft cockpit salon and table



Jeanneau Merry Fisher 605 - bow



Jeanneau Merry Fisher 605 - on the water



Jeanneau Merry Fisher 605 - swim transom and swim platforms



Jeanneau Merry Fisher 605 - wheelhouse with port side salon



Jeanneau Merry Fisher 605 - saloon table converts to berth



Jeanneau Merry Fisher 605 - storage under seating



Jeanneau Merry Fisher 605 - wheelhouse view towards helm seat



Jeanneau Merry Fisher 605 - helm position with dash and starboard side window



Jeanneau Merry Fisher 605 - helm seat folds forwards for access to galley



Jeanneau Merry Fisher 605 - helm seat



Jeanneau Merry Fisher 605 - diagram of side view



Jeanneau Merry Fisher 605 - diagram of overhead view



Jeanneau Merry Fisher 605 - diagram of wheelhouse layout

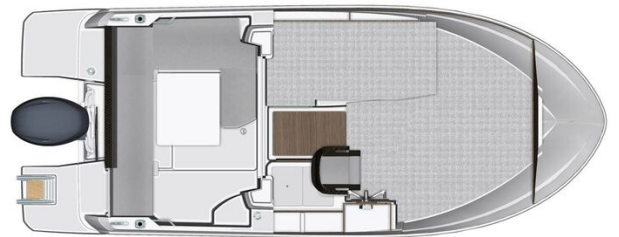

Jeanneau Merry Fisher 605 - diagram of cabin layout



Jeanneau Merry Fisher 605 - on the water



Jeanneau Merry Fisher 605 - relaxing in the aft cockpit



Jeanneau Merry Fisher 605 - great for fun on the water



Jeanneau Merry Fisher 605 - relaxing on the aft sun lounger

**Morgan Marine**

The Boatyard, Shipyard Estate  
CO7 0AR Colchester  
United Kingdom (UK)

Phone: 44(0)1206302003

<https://morganmarine.com>

